

300 Series

- Spun round
- 1/8" taper per foot
- Available in lengths up to 36'

Pole Dimensions

Pole No.	[A] Above Ground Height	[B] Burial Depth	[C] Tip Diameter	[D] Base Diameter	Est. Pole Weight (lbs)*
D312	12'	5'	5"	6-1/2"	500
D313	13'	5'	5"	6-5/8"	550
D315	15'	5'	5"	6-7/8"	600
D316	16'	5'	5"	7"	650
D317	17'	5'	5"	7-1/8"	700
D318	18'	5'	5"	7-1/4"	775
D320	20'	5'	5"	7-1/2"	850
D323	23'	5'	5"	7-7/8"	1,000
D324	24'	5'	5"	8"	1,050
D325	25'	5'	5"	8-1/8"	1,100
D328	28'	5'	5"	8-1/2"	1,300
D330	30'	6'	5"	8-3/4"	1,450

*Pole weight may vary based on color of aggregate.

Pole Code

Mounting Type	Series + Above Ground Height	Color	Finish	Sealer	Options
(D) Direct Burial (A) Anchor Base	312 313 315 316 317 318 320 323 324 325 328 330	(SG) Sky Gray (PG) Pearl Gray (SP) Salt & Pepper (CN) Cinnamon (BZ) Bronze (CB) Charcoal Black (MS) Midnight Sky Black (EB) Eclipse Black (DB) Dark Black (SR) Sedona Red (AR) Antique Red (RG) Red Granite (TC) Terra Cotta (KG) Kelly Green (AW) Alpine White	(E) Etched	(A) Acrylic (W) Waterseal (G) Anti-Graffiti	(B) Banner Arm (F) Finial (I) Threaded Insert (O) Outlet (T) Tenon (TEA) Tapered Elliptical Arm Standard tenon size 2-7/8" OD x 3" tall

Example Code: **D312** - **SG** - **EA** - **3T**

Base Detail

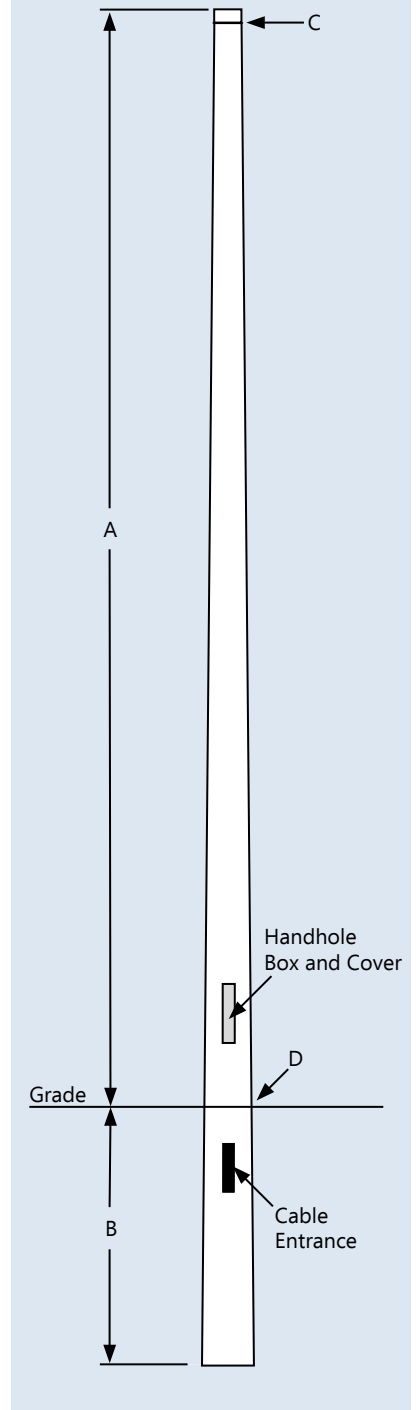
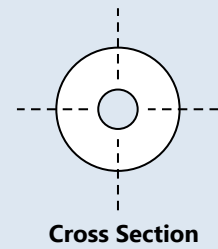
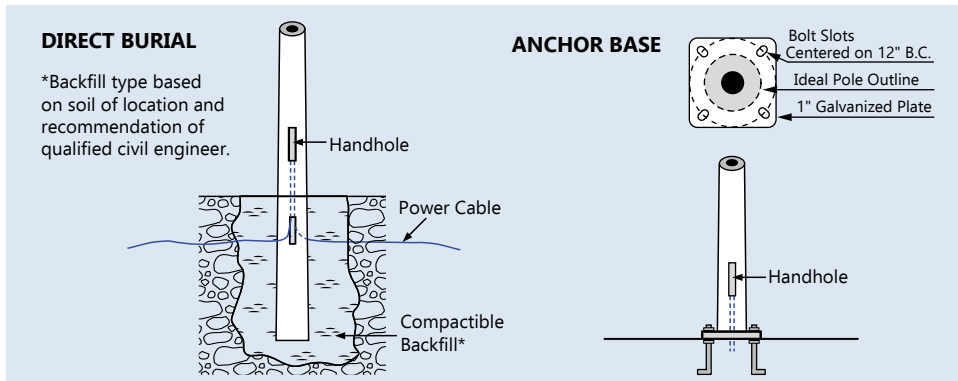

PO Box 157
W142 N9110 Fountain Blvd.
Menomonee Falls, WI 53052-0157
(888) 719-7599
(262) 250-7598 fax
info@concretepoles.com
www.concretepoles.com